



**CONTROL
FLOW
INC.**



FLOCON MO-COMP **WESTECH** RETSCO

Ultimate Mo-Comp Cylinder (UMCCA)[™]

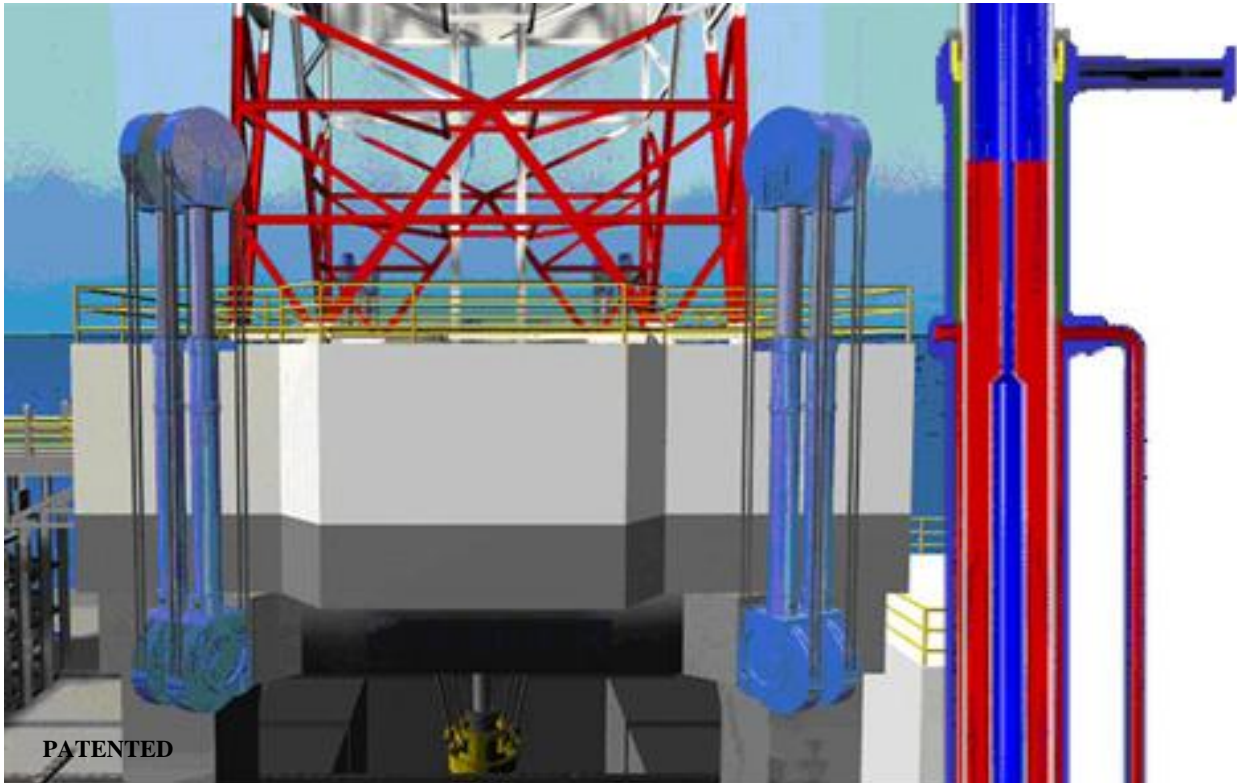

The **Patented Ultimate Mo-Comp Cylinder Assembly (UMCCA)** is a design that is different from most conventional compensator assemblies. The UMCCA integrates the accumulator into the cylinder itself. The hydraulic fluid is stored inside the hollow ram and is pressurized with high-pressure air via an air transfer tube. This arrangement provides an air over oil operation. The air pressure acting on the internal surface of the rod provides the force to extend the rod. The rod extends with a force relative to the system air pressure, however with the lower end of the rod submerged in the fluid, hydraulic dampening is maintained to prevent excessive rod speeds.

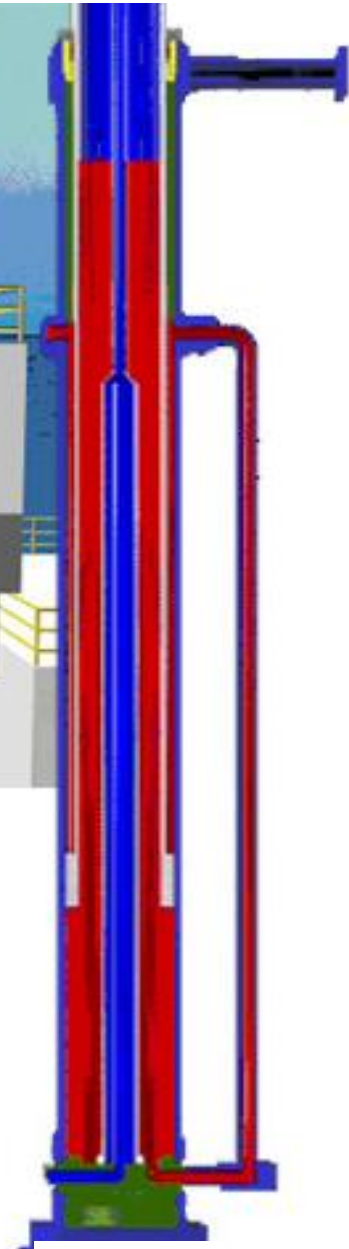

Control Flow/Mo-Comp Products

Efficient Motion Compensation Solutions

Contact a Control Flow, Inc. sales representative for further detailed information

Control Flow, Inc. • 9201 Fairbanks N. Houston Rd. • Houston, Texas 77064-6206 • Phone (281) 890-8300

Fax (281) 890-3947 • E-mail: sales@controlflow.com • Web: www.controlflow.com

Copyright Control Flow, Inc. 2008